

23rd Seed Institute Conference



**UCLA Luskin Conference Center
Los Angeles, California
April 22nd -23rd, 2017**

**UCLA Luskin Conference Center
425 Westwood Plaza
Los Angeles, CA 90095**

Conference Center Phone: 310-206-8585
Bob Goldberg's Cell Phone Number: 310-600-6484
Lauren Bowman's Cell Phone Number: 312-282-8958

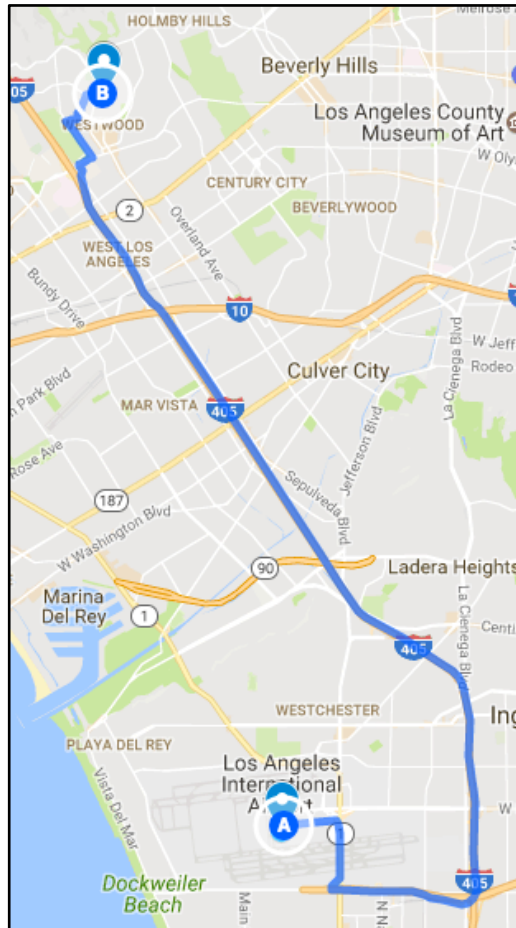

Directions to the UCLA Luskin Conference Center

<http://luskinconferencecenter.ucla.edu/about/campus-map-parking/>

- **Take San Diego Freeway (I-405) North and exit at Wilshire Boulevard East.**
- **Turn right onto Wilshire Boulevard and proceed a half mile to Westwood Boulevard**
- **Turn left and the UCLA Luskin Conference Center is located one mile ahead at end of the turnaround.**

Weather, Driving Conditions, and Traffic

Based on the average weather conditions in Los Angeles for late April, you can expect temperatures in the mid-70's with sunshine.

You can check current traffic when you arrive in Los Angeles using the following websites:

1. Cal-Trans Highway: www.dot.ca.gov/cgi-bin/roads.cgi

Phone: (800) 427-7623 (Enter the number of the highway (18 or 173) then enter #

REMINDERS & UCLA CONFERENCE CENTER INFORMATION

Please note that the meeting **starts promptly at 1:40 PM on Saturday, April 22nd**. You will be able to store your bags when you arrive (check-in time is not until 4:00 pm). Lunch will be served at 12:30 pm in the Illumination Room (see map). Breakfast, but not lunch, will not be provided on Sunday. **Please bring your meal vouchers to each meal.**

CHECK-IN TIME:	Saturday, April 22nd	4:00 pm
CHECK-OUT TIME:	Sunday, April 23rd	12:00 pm

MEAL TIMES:

Lunch Saturday:	12:30-1:30	pm
Dinner Saturday (Faculty Center):	7:10	pm
Breakfast Sunday in Plateia Restaurant:	7-9:00	am

It is the policy of the UCLA Conference Center that guests may not bring in their own food for meals, meetings, and socials. Full service is provided by the Conference Center.

THE UCLA CONFERENCE CENTER HAS A SMOKE-FREE ENVIRONMENT POLICY IN ALL BUILDINGS INCLUDING GUESTROOMS, MEETING ROOMS, AND SOCIAL ROOMS.

Saturday, April 22nd, 2017

12:30 pm **CHECK-IN –DROP BAGS FOR STORAGE-LUNCH IN ILLUMINATION ROOM**
(LEVEL 2, see map) **Bring Lunch Voucher**

Entrepreneur Room (Level 2, see map)

1:40 pm **SESSION I – GOLDBERG LAB (UCLA)**

Introduction

Bob Goldberg

2:00 pm *The Functional Role of DNA Methylation During Seed Development*

Jer-Young Lin

2:30 pm *Searching for DNA Methylation Valleys (DMVs) That Are Devoid of Methylation During Seed Development and Post-Germination*

Min Chen

3:00 pm **SESSION II – HARADA LAB (UC Davis)**

Introduction

John Harada

3:05 pm *LEC1 Gene Regulatory Networks Throughout Seed Development*

Julie Pelletier

3:30 pm *Transcription Factor Regulatory Networks in Soybean Seed Maturation*

Leonardo Jo

4:00 pm *Development of a Protoplast System for the Functional Analysis of Transcription Factors*

Ssu-Wei Hsu

4:30 pm *Analysis of the Small RNAome of Soybean Seeds*

Rie Uzawa & Ssu-Wei Hsu

5:00 pm **SESSION III – FISCHER LAB (UC Berkeley)**

Introduction & Presentation: The FACT Complex is Required for DNA Demethylation at Heterochromatin During Reproduction in Arabidopsis

Bob Fischer

5:30 pm *DNA Methylation Reprogramming and Efficient Maintenance of CG Methylation in the Arabidopsis Male Sexual Lineage*

Ping-Hung Hsieh

6:00 pm

Active DNA Demethylation in Plant Sex Cells
Yvonne Kim

6:45

Discussion

7:00

Leave for Dinner at the Faculty Center

Sunday, April 23rd, 2017

7:00-9:00 am

Complimentary breakfast in Plateia restaurant at the Luskin Center for all symposium attendees
(Please bring your meal voucher)

Seed Institute Attendees	
Bob Goldberg	bobg@ucla.edu
Jer Young Lin	lin51@ucla.edu
Min Chen	m.chen@ucla.edu
Allen Chung	allen.whsib@gmail.com
Brandon Le	brandon.le@ucr.edu
Lauren Bowman	laurenbowman@ucla.edu
John Harada	jjharada@ucdavis.edu
Julie Pelletier	jpelletier@ucdavis.edu
Ssu-Wei Hsu	suwhsu@ucdavis.edu
Leonardo Jo	ljo@ucdavis.edu
Rie Uzawa	ruzawa@ucdavis.edu
Robert Fischer	rfischer@berkeley.edu
Ping-Hung Hsieh	hsiehph@berkeley.edu
Yvonne Kim	yvonnekim@berkeley.edu

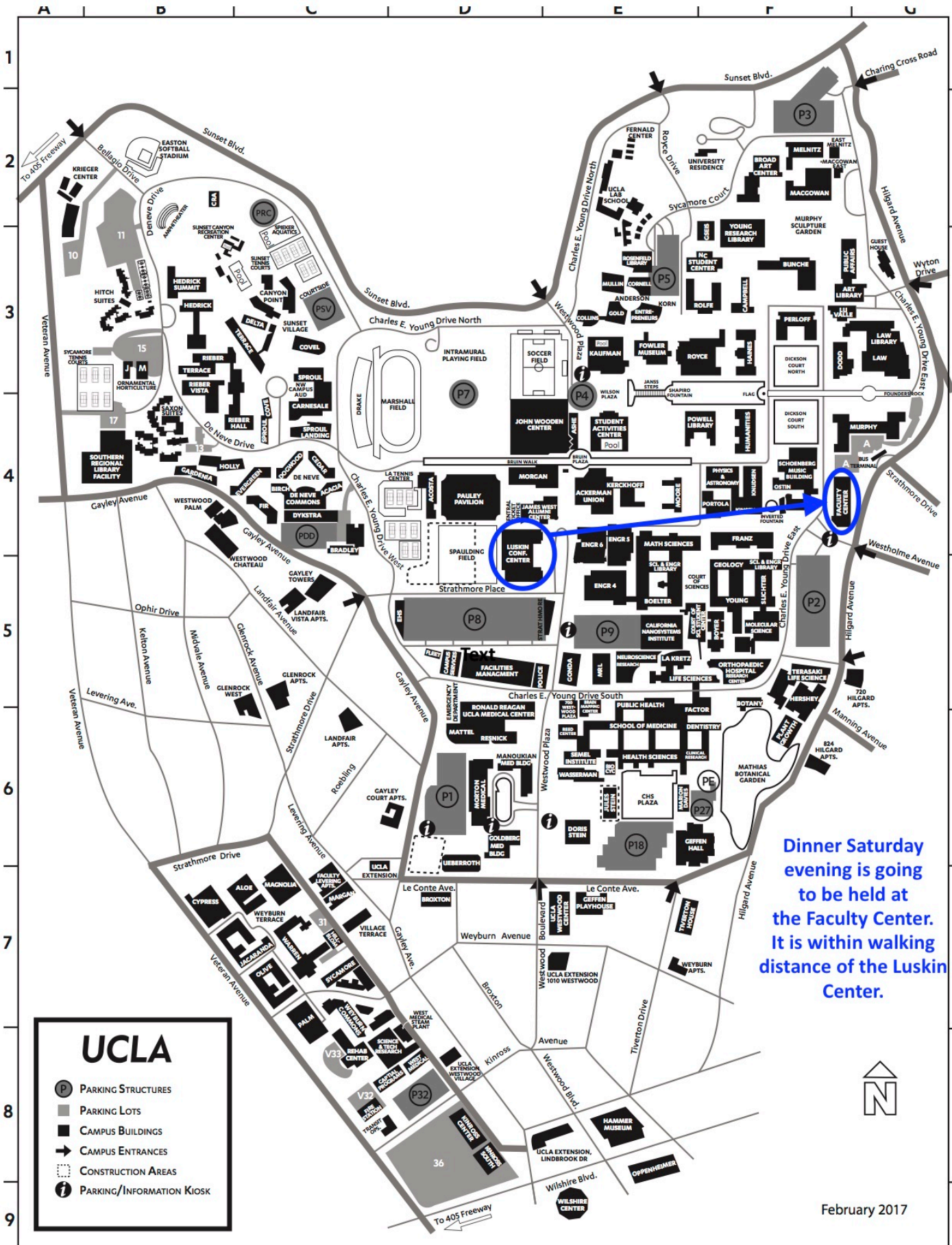

Dinner Saturday evening is going to be held at the Faculty Center. It is within walking distance of the Luskin Center.



UCLA

- PARKING STRUCTURES
- PARKING LOTS
- CAMPUS BUILDINGS
- CAMPUS ENTRANCES
- CONSTRUCTION AREAS
- PARKING/INFORMATION KIOSK

MEETING SPACE: LEVEL 2

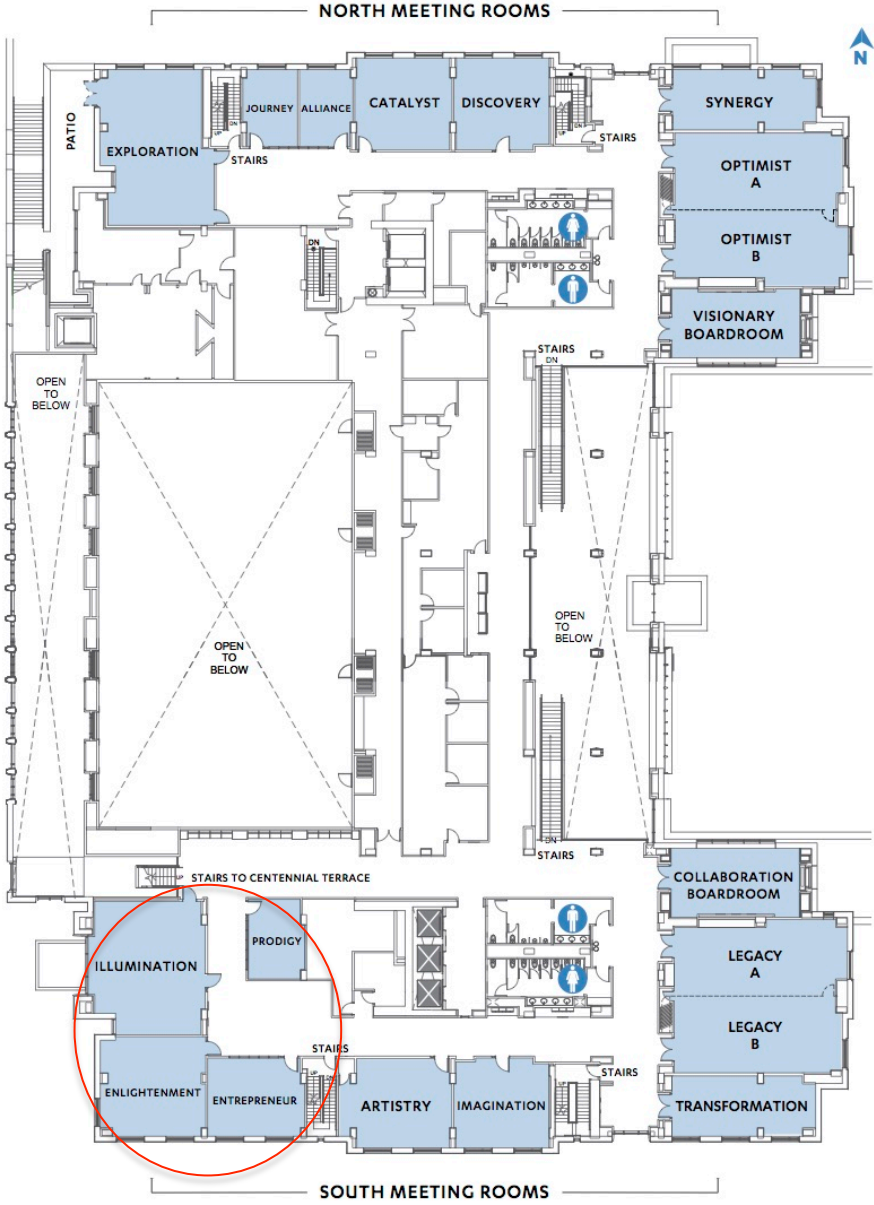

For information on advance reservations for the UCLA Meyer and Renee Luskin Conference Center, please call 855-LCC-UCLA (855-522-8252) or visit LuskinConferenceCenter.UCLA.edu